

# TE1360 Mini plug up to 540°C

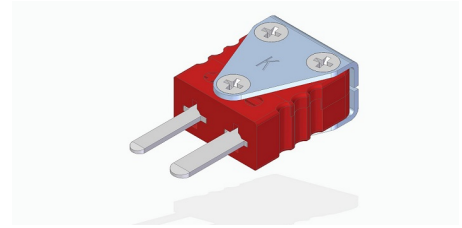

<b>Application</b>	
<b>Connector</b>	Thermocouple and RTD circuits
<b>Design</b>	Suited for small wires and mineral insulated cables
<b>Materials</b>	Glass filled thermoplastic body with original thermocouple material pins
<b>Temperature rating</b>	
<b>Temperature limit</b>	Continuous 425°C, maximum 540°C
<b>Construction</b>	
<b>Body</b>	Glass filled thermoplastic material
<b>Design</b>	Rugged one body design
<b>Wire size</b>	
<b>Accepts wires</b>	From 0,002 mm to 0,6 mm
<b>Cable jacket diameter</b>	Maximum 4,5 mm.
<b>Accessories</b>	
<b>Color code</b>	
<b>Available colors</b>	<b>Brown only, without color pigment. Thermocouple calibration printed</b>

## Ordering code

\*This datasheet is purely indicative, build-up of model code may vary from this datasheet.

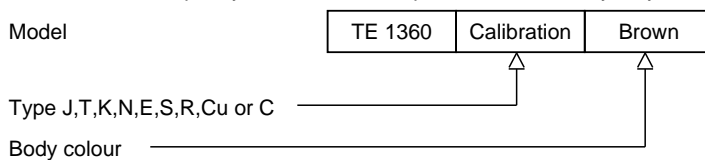

H9-1 Rev.0 7/07