

# TE1034 Standard panel jack 3-pole with lugs

## Application

**Female panel connector** Thermocouple and RTD circuits

**Third connection** Third connection for ground, continuous shield or for three wire RTD.

## Construction

**Contacts** Springloaded Cu, or thermocouple contacts

**Materials** Glass filled thermoplastic body with original thermocouple material contacts

**Temperature limit** Maximum 220°C

**Body** Glass filled thermoplastic material

**Molded barriers** Prevent short circuit

**Wire size** From 0,2mm to 2,0mm.

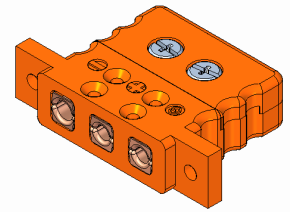

## Ordering code

\*This datasheet is purely indicative, build-up of model code may vary from this datasheet.

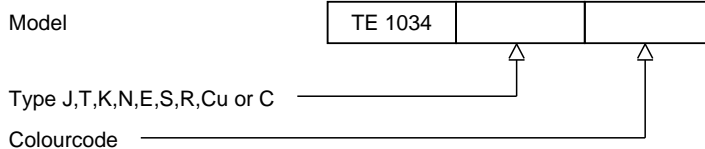

H9-2Rev.0 7/07