

TE1544 Mini panel jack round

Application

Female panel connector	Thermocouple and RTD circuits
Contacts	Springloaded thermocouple contacts
Materials	Glass filled thermoplastic body with original thermocouple material contacts

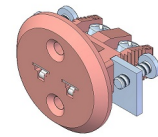

Temperature rating

Temperature limit	Maximum 220°C
--------------------------	---------------

Construction

Body	Glass filled thermoplastic material
Design	Stainless steel bracket mounted with 2 screws
Molded barriers	Prevent short circuit

Wire size

Accepts wires	From 0,2mm. to 2,0mm.
----------------------	-----------------------

Ordering code

*This datasheet is purely indicative, build-up of model code may vary from this datasheet.

Model

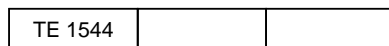

Type J, T, K, N, E, S, R, Cu or C

Colourcode

H9-2Rev.0 7/07