

# TE1210ML Mini jack with lock mechanism

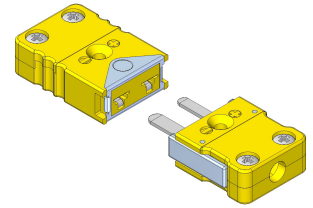

## Application

**Connector** Self locking connector pair for thermocouple and RTD circuits. Locking feature prevents unwanted disconnection due to vibration etc. Suited for small wires and mineral insulated cables.

## Construction

**Temperature limit** Maximum 200°C

**Design** Rugged one body design

**Body material** Glass filled high quality thermoplastic body with original thermocouple material pins and springloaded inserts.

**Pins** Polarized pins ensure proper connection

**Molded barriers** Prevent short circuit

**Termination** Stainless Steel screws with Phillips head

**Locking mechanism** Stainless steel locking clip

**Wire size**

**Accepts wires** Accepts wires up to 0.6mm  
Maximum cable diameter 4.5mm

**Colourcode**

Available in all color code standards incl. NFE, BS, JIS, etc

## Ordering code

\*This datasheet is purely indicative, build-up of model code may vary from this datasheet.

